

# SYSTEM ONE® PARTS

PN: 967125 PARTS LIST

**1301-C02-06**

## Frame A and LD17 Size 3x4-10

Keep with Instructions 1301-C00 for Installation, Operation and Maintenance

Section	1301
Effective	Oct 2013
Replaces	Jan 2013

	Page
X-Section Drawings	
Frame A	2
LD17	3
Casings & Impellers (Ref #1 & 2)	4
Shafts / Rotating Elements (ref #6)	5
Back Covers (Ref #11)	6
Other Parts (Ref #16 - 506)	7 - 8

Frame A and LD17 pumps share all parts except:

Ref 6	Shafts and Rotating Elements
Ref 11	Backcovers (& hardware)
Ref 71	Frame Adaptors

### Recommended Spare parts (Ref # is shaded.)

Ref #	Description
2	Impeller
6-RE	Rotating Element
72	Frame Adapter O-ring
73A	Casing Gasket
80	Mechanical Seal
89B	Lab Seal Rotor (w/ O-ring), Thrust Bearing
89E	Lab Seal Rotor (w/ O-ring), Radial Bearing
405	Cartridge O-ring



T: 616-241-1611 • Fx: 616-241-3752  
1809 Century Avenue, Grand Rapids, Michigan 49503, U.S.A

[www.blackmer.com](http://www.blackmer.com)

## Frame-A Cross Section

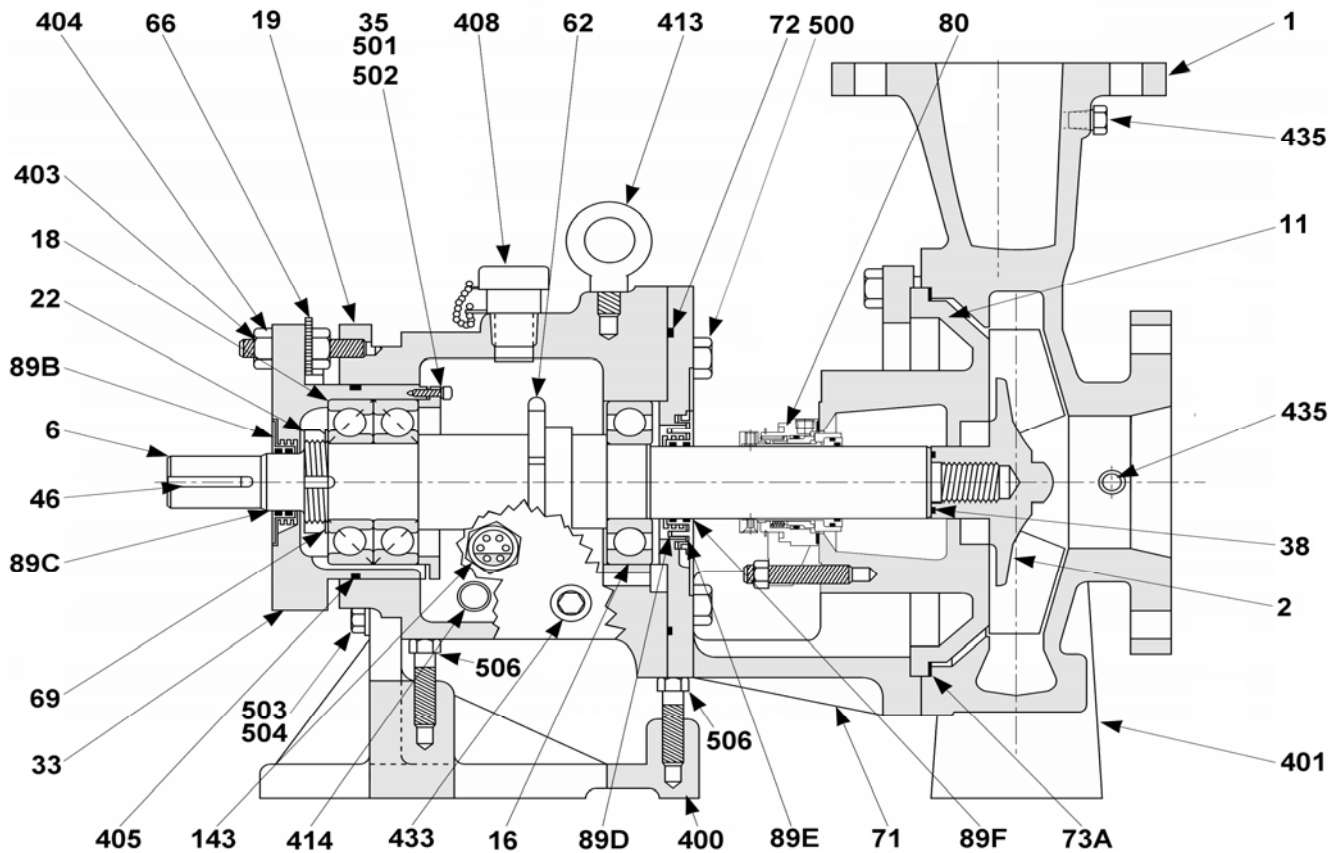

Ref.	Description	Ref.	Description	Ref.	Description
1	Casing	69	Lockwasher, Thrust Bearing	403	Stud, Cartridge
2	Impeller	71	Frame Adapter	404	Locknut, Cartridge
6	Shaft	72	O-Ring, Frame Adapter	405	O-Ring, Cartridge
11	Back Cover	73A	Gasket, Casing	408	Oil Filler Assembly
16	Bearing, Radial	80	Mechanical Seal	413	Bolt, Eye
18	Bearing, Thrust	89A	Seal, Labryinth Stator, Thrust *	414	Plug, Magnetic
19	Bearing Frame	89B	Seal, Labryinth Rotor, Thrust	433	Plug, Bearing Frame
22	Locknut, Thrust Bearing	89C	Seal, Labryinth O-Ring, Thrust	435	Plug, Casing
33	Bearing Cartridge	89D	Seal, Labryinth Stator, Radial	500	Cap Screw, Frame Adapter
35	Retainer Cover	89E	Seal, Labryinth Rotor, Radial	501	Screw, Retainer Cover
38	O-Ring, Impeller Hub	89F	Seal, Labryinth O-Ring, Radial	502	Washer for 501
46	Key, Coupling	143	Oil Sight Glass	503	Screw, Bearing Frame Foot
62	Flinger	400	Foot, Bearing Frame	504	Washer for 503
66	Micrometer Nut	401	Foot, Casing	506	Bolt, Bearing Frame Support

\* 89A Incorporated as part of the cartridge after Mar. 2000 (not shown)

LD17 Cross Section

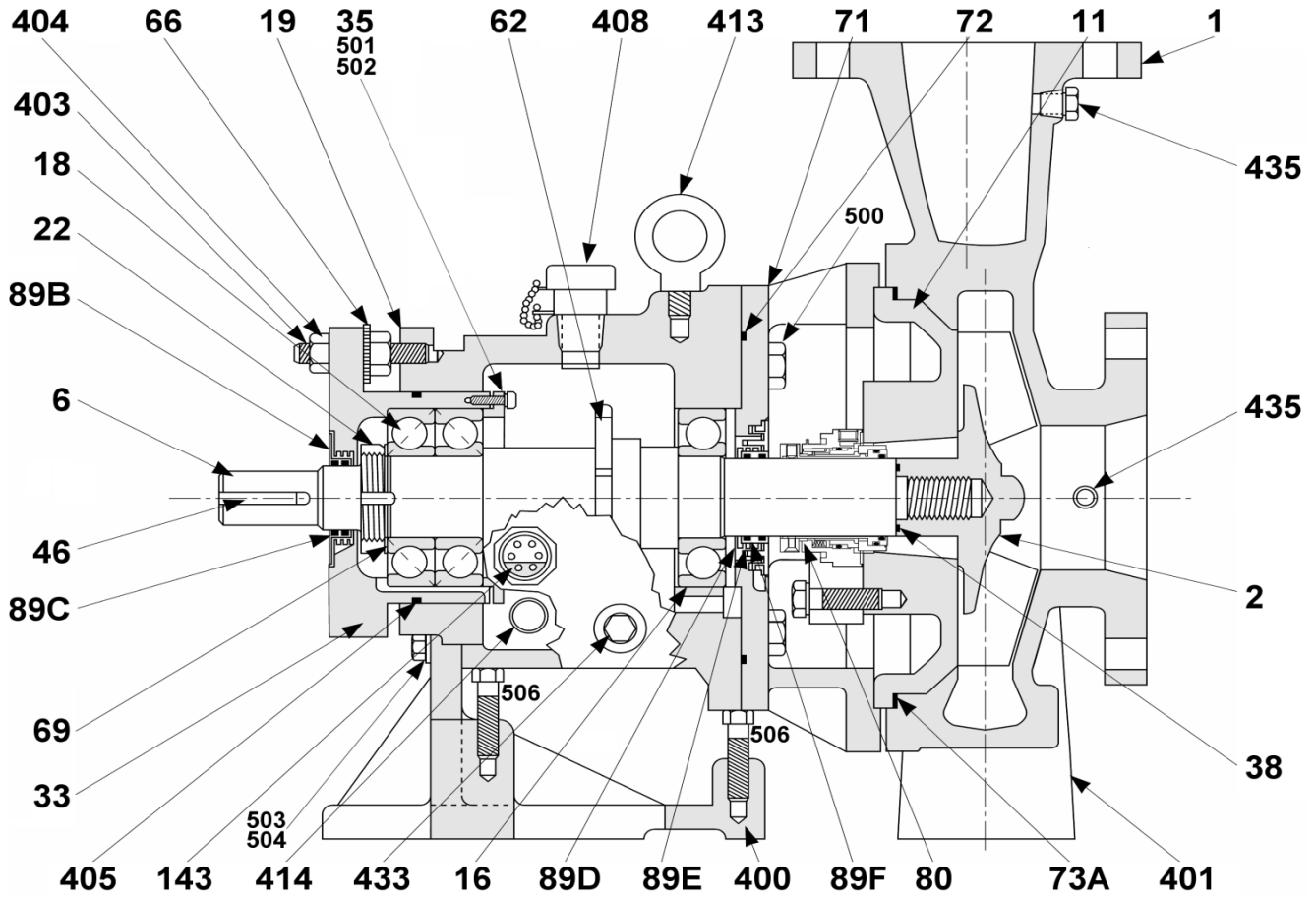

Ref.	Description	Ref.	Description	Ref.	Description
1	Casing	69	Lockwasher, Thrust Bearing	403	Stud, Cartridge
2	Impeller	71	Frame Adapter	404	Locknut, Cartridge
6	Shaft	72	O-Ring, Frame Adapter	405	O-Ring, Cartridge
11	Back Cover	73A	Gasket, Casing	408	Oil Filler Assembly
16	Bearing, Radial	80	Mechanical Seal	413	Bolt, Eye
18	Bearing, Thrust	89A	Seal, Labryinth Stator, Thrust *	414	Plug, Magnetic
19	Bearing Frame	89B	Seal, Labryinth Rotor, Thrust	433	Plug, Bearing Frame
22	Locknut, Thrust Bearing	89C	Seal, Labryinth O-Ring, Thrust	435	Plug, Casing
33	Bearing Cartridge	89D	Seal, Labryinth Stator, Radial	500	Cap Screw, Frame Adapter
35	Retainer Cover	89E	Seal, Labryinth Rotor, Radial	501	Screw, Retainer Cover
38	O-Ring, Impeller Hub	89F	Seal, Labryinth O-Ring, Radial	502	Washer for 501
46	Key, Coupling	143	Oil Sight Glass	503	Screw, Bearing Frame Foot
62	Flinger	400	Foot, Bearing Frame	504	Washer for 503
66	Micrometer Nut	401	Foot, Casing	506	Bolt, Bearing Frame Support

\* 89A Incorporated as part of the cartridge after Mar. 2000 (not shown)



<b>Ref #1</b>		<b>Casing Assembly Frame A and LD17</b>		<b>3x4-10</b>			
Casings assemblies do not include gaskets (see item 73A) or feet (see item 401).							
<b>Options</b>		<b>Material - Part Number for Casing Assembly</b>					
Flange	Other	DI	CF8M	CD4	CN7M	HB	HC
150FF	- Drain LSD RSD	090802 696957	098212	098084	363666		982403
150RF	- Drain LSD RSD	801340 982853	801269				
300FF	- Drain LSD RSD	090818	098573				
300RF	- Drain LSD RSD						
<b>Hardware included in STANDARD casing assemblies (material may differ from casing)</b>							
Ref.	Description	pts/pump	DI/CF/CD	CN7M	HB	HC	
435	Plug for gage tap	2	098395	350664	628343	628482	
*	Stud for adaptor	8		098281			
*	Nut for stud	8		098289			
*	Bolt for casing foot	4		098278			
*	Washer for bolt	4		098318			
*	Drain Plug (optional)	1	098280	098008		981101	

\* Not depicted in drawing

<b>Ref #2</b>		<b>Impeller Assembly Frame A and LD17</b>		<b>3x4-10</b>			
Impeller assembly includes trim, ISO G 6.3 balance and PTFE O-ring (098296). Specify trim at time of order. Unspecified impellers ship with full trim. There is a charge to retrim impellers after shipment. (981631) Lock Bolt impeller assembly also includes lock bolt (640644) and washer (628585). Keyed impeller assemblies includes Bolt, Bushing, Jack screws, and O-ring. (CF for part #s)							
Ref #	Impeller Type	CD4	CF8M	CN7M	HB	HC	
2	Standard Lock Bolt* Keyed*	098226		363667		685151	
						628428	

\* Not depicted in drawing



**6 Shaft Assemblies and Rotating Elements.**

**17-4Ph shaft material is required for the following sizes operated over 1800 rpm: 4x6-10 and all 13".**

Ref# 6-RE: Rotating Element Includes shaft assembly (6-SA), bearings (16&18), bearing cover (35), flinger filter (62).

Ref# 6-SA: Shaft Assembly Includes shaft (6), locknut (22), locknut washer (69), and key (46).

(Ref# 6-SA: Shaft Assembly for keyed impellers also include impeller key as noted.)

All shafts are stated material in the wet end portion and carbon steel in the power end portion.

Ref.#	Description	Parts/pump	Part #	Note
6-RE FRA	Rotating Element Frame-A 316/CS	1	364152	
	Rotating Element Frame-A 316/CS Vertical		059353	
	Rotating Element Frame-A 17-4/CS		099917	
	Rotating Element Frame-A 17-4/CS Vertical		364242	
	Rotating Element Frame-A A20/CS		097722S	
	Rotating Element Frame-A HC/CS		097746	
	Rotating Element Frame-A HB/CS		628849	
	Rotating Element Frame-A 316/CS Lock Bolt		981795	
	Rotating Element Frame-A 17-4/CS Lock Bolt		981796	
6-SA FRA	Shaft Assembly Frame-A 316/CS	1	364153	
	Shaft Assembly Frame-A 17-4/CS		099918	
	Shaft Assembly Frame-A A20/CS		097721	
	Shaft Assembly Frame-A HC/CS		097745	
	Shaft Assembly Frame-A HB/CS		628850	
	Shaft Assembly Frame-A 316/CS Lock Bolt		981791	
	Shaft Assembly Frame-A 17-4/CS Lock Bolt		981792	
6-RE LD17	Rotating Element LD17 316/CS	1	099706	
	Rotating Element LD17 316/CS Vertical		059340	
	Rotating Element LD17 17-4/CS		099920	
	Rotating Element LD17 17-4/CS Vertical		090964	
	Rotating Element LD17 A20/CS		628943	
	Rotating Element LD17 HC/CS		685255	
	Rotating Element LD17 HB/CS		628333	
	Rotating Element LD17 316/CS Lock Bolt		981797	
	Rotating Element LD17 17-4/CS Lock Bolt		981798	
	Rotating Element LD17 17-4/CS 1.25" Thread		640681	Use over 150hp
	Rotating Element LD17 17-4/CS Keyed 1.84" Hub	643161	All except 1x2-10	
	Rotating Element LD17 17-4/CS Keyed 1.47" Hub	090983	1x2-10 Only	
6-SA LD17	Shaft Assembly LD17 316/CS	1	098422	
	Shaft Assembly LD17 17-4/CS		099922	
	Shaft Assembly LD17 A20/CS		628942	
	Shaft Assembly LD17 HC/CS		685256	
	Shaft Assembly LD17 HB/CS		628331	
	Shaft Assembly LD17 316/CS Lock Bolt		981793	
	Shaft Assembly LD17 17-4/CS Lock Bolt		981794	
	Shaft Assembly LD17 17-4/CS 1.25" Thread		640680	Use over 150hp
	Shaft Assembly LD17 17-4/CS Keyed 1.84" Hub (includes 350161 key)		643143	All except 1x2-10
Shaft Assembly LD17 17-4/CS Keyed 1.47" Hub (includes 360698 key)	090977	1x2-10 Only		
<p>Original Frame-A design uses 5310 thrust bearing and shaft is 1.125" at the coupling end.</p> <p>If ordering a shaft assembly or a rotating element for an original ANSI Fame-A power end, it is highly recommended that the power end be converted to the current standard with angular contact thrust bearings. This can be accomplished by using a current design rotating element (as listed above), thrust labyrinth seal, and a new coupling half for the larger shaft diameter.</p> <p><b>Parts required to convert ANSI Original Frame-A Power End (1.125" cplg. end ) to current design (1.375" cplg. end):</b></p> <p>1 ea Rotating Element Frame-A see table above for PN</p> <p>1 ea Thrust Lab Seal Stationary 1.50" NPS** 364238**</p> <p>1 ea Thrust Lab Seal Rotary 1.50" 316SS 090697</p> <p>1 ea Coupling half for 1.375" shaft by others</p> <p>** If cartridge (33) is also being replaced, this item is unnecessary.</p>				



**REF #11 Back Cover Assemblies Frame-A**

Cover includes integral seal chamber and is backwards compatible with old two piece design.  
 Cover assembly does not include gasket (73A).  
 Cover assembly machined for bushing does not include bushing.  
 Cover assembly machined for jacket does not include the jacket.  
 Cover assembly machined for tap includes plug for tap (361388). CN7M, HB, HC covers use same alloy plugs.

Bush/Other options	DI	CF8M	CD4MCu	CN7M	HB	HC
<b>10 inch Frame A</b>	Part Number for Back Cover Assembly					
Standard for carbon bush	363765	364160	364189	059442		059322
For jacket	059463	059465	981017			
With tap						
For jacket/with tap						
Optional for Enviroseal	640663	644457	983074			
For jacket		801204				
With tap						
For jacket/with tap						

**REF #11 Back Cover Assemblies LD17**

Cover includes integral seal chamber and is backwards compatible with old two piece design.  
 Cover assembly does not include gasket (73A).  
 Cover assembly machined for bushing does not include bushing.  
 Cover assembly machined for tap includes plug for tap (361388). CN7M, HB, HC covers use same alloy plugs.  
 Seal chamber jacket not available on LD17.

Bush/Other options	DI	CF8M	CD4MCu	CN7M	HB	HC
<b>10 inch LD17</b>	Part Number for Back Cover Assembly					
No bushing	363937	685050	697836	090999		982400
with tap	982854					
Carbon/14K	097404	685287				
with tap						
EnviroSeal	643283	643410	628769			
with tap						

**Hardware included with standard Back Cover Assemblies**

Ref.	Description	Frame A		LD 17		Comment/Note
		Qty	Part No.	Qty	Part No.	
*	Gland Stud	4	360642	NA		
*	Nut for Gland Stud	4	098316	NA		
*	Gland Bolt	NA		4	364229	
*	Washer for Gland Bolt	NA		4	090696	
*	Mounting Stud	2	098301	2	098301	
*	Nut for Mounting Stud	2	098302	2	098302	

**Optional Seal Chamber Jacket for Frame-A (Requires Back Cover for Jacket. Not available for LD17.)**

Ref.	Description	Parts /pump	Part No.	Comment/Note
*	Jacket Assembly for Seal Chamber Frame-A only	1	090873	
*	Jacket for Seal Chamber Frame-A only	1	363015	Included in Jacket Assembly
*	O-Ring for Seal Chamber Jacket Frame-A only	2	360976	Included in Jacket Assembly
*	Screw for Seal Chamber Jacket Frame-A only	1	360362	Included in Jacket Assembly

\* Not depicted in drawing



Ref.#	Description	Parts/pump	Part No.	Note
16	Radial Bearing 6310 C3	1	098381	Included in #6-RE
	Radial Bearing 6310-Z C3 (Grease Lube and Vertical)		098732	Included in #6-RE
18	Thrust Bearing 7310 BEGAY (2 required)	2	098054	Included in #6-RE
19	Bearing Frame Assembly Includes: bearing frame (19), sight glass (143), stud (403), oil cap (408), eyebolt (413), plugs (414 and 433).	1	098299	
	Bearing Frame Assembly (Grease Lube and Vertical)		099537	
22	Bearing Locknut N10	1	098383	Included in #6-SA
33	Cartridge Assembly for Thrust Bearing	1	801140	
	Includes: cartridge (33), screw (501), washers (502), O-ring (405).		099513	
35	Retainer Cover	1	098371	Included in #6-RE
	Retainer Cover (Grease Lube and Vertical)	1	361491	Included in #6-RE
38	O-ring Impeller PTFE 2-027	1	098296	Included in #2 assy
	O-ring Impeller: pure PTFE 2-029 for keyed impellers after Mar. 2000		098880	Included in #2 assy
	O-ring Impeller: PTFE Encapsulated 2-029 for keyed after Mar. 2000		002998	Special Order
Keyed impellers prior to March 2000 had no O-ring.				
46	Key	1	059241	Included in #6-SA
62	Flinger Filter	1	098385	Included in #6-RE
66	Micrometer Nut SS	3	098376	
69	Bearing Lockwasher W10	1	098384	Included in #6-SA
71	Frame Adapter Frame-A	1	098297	
	Frame Adapter LD17		099605	
	Frame Adapter Frame-A (Grease Lube and Vertical)		364243	
	Frame Adapter LD17 (Grease Lube and Vertical)		099796	
72	Frame Adapter O-ring (2-265 Buna)	1	098396	Included in #71 assy
73A	Casing Gasket 8/10 CFN .06	1	363409	
	Casing Gasket 8/10 CFN .09		363410	
	Casing Gasket 8/10 RG0 .12		059209	
	Casing Gasket 8/10 RPE .06		808314	
	Casing Gasket 8/10 RPE .09		Special	
	Casing Gasket 8/10 PTFE .06		099543	
Casing Gasket 8/10 PTFE .09	Special			

**Material Key for Wet End Gaskets**

Abv	Description	Application	Old Type
CFN	Carbon Fiber with Nitrile binder (Std DI-CF8-CD4)	General	197
RG0	Reinforced Graphite no binder	High Temperature	199
RPE	Reinforced PTFE	Hi Temperature/Pressure	196
PTFE	PTFE Style 2000 (Std A20-HB-HC)	Chemical Resistance	2000



Ref.#	Description	Parts/pump	Part No.	Note
80	Mechanical Seal - See mechanical seal pages	1		
89A	Thrust Lab seal Stationary 1.50" NPS (before May 2000)	1	364238	
Frame-A and LD17 pumps built after May 2000 do not use thrust lab seal stationaries.				
89B	Thrust Lab Seal Rotary 1.50" 316SS	1	090697	
89C	Thrust lab seal rotary O-ring 1.50" (2-128)	2	099924	Included in #89B assy
89D	Radial Lab Seal Stationary 1.87" NPS	1	364240	
89E	Radial Lab seal Rotary 1.87" 316SS	1	098478	
89F	Radial lab seal rotary O-ring (2-134)	2	098374	Included in #89E assy
143	Oil sight glass 1.00-11.5 NPT	1	098306	2nd SG optional
400	Bearing Frame Foot for 8.25" pumps without C-frame Adaptor	1	059293	Marked 2536
	Bearing Frame Foot 10.00" pumps without C-frame Adaptor		059295	Marked 2537
	C-Frame Adaptor Foot for 8.25" pumps	2	059297	Marked 2538
	C-Frame Adaptor Foot for 10.00" pumps		059293	Marked 2536
If C-frame adaptor is used, use C-frame adaptor feet attached to adaptor rather than bearing frame foot attached to frame. Bearing Frame Feet and C-Frame Adaptor feet include ref. 503, 504 & 506.				
401	Casing Foot for Centerline Mount 3x4-10	2	098292	Marked A306
	Casing Foot for Side Discharge	1	CF	
403	Micrometer stud 1/2-20 UNF SS	3	098366	
404	Cartridge Locknut 1/2-20 UNF SS	3	098377	
405	Cartridge O-Ring (2-248 Buna)	1	098375	Included in #33 assy
408	Oil Filler & Cap Assembly	1	098364	
413	Lifting Eyebolt .50-13	1	098365	
414	Magnetic Plugs .50-14 NPT	2	098363	
433	Oil drain plug .25-18 NPT	1	099792	
435	Plug for suction or discharge tap	1 or 2	Varies by mat'l	See Ref #1 Casing assy
500	Bolt for frame adaptor (HHCS .62-11x1.25)	4	098331	
501	Retainer Cover Socket Head Cap Screws 10-32	8	098387	Included in #33 assy
502	Washer for 501	8	098389	Included in #33 assy
503	Screw, Bearing Frame Foot	2	350729	
504	Washer for Screw 503	2	350727	
505	Jackscrew - Hex Head Cap Screw	2	098278	Included in #71 assy
506	Screw, Bearing Frame Support	2	350728	
*	Temperature Monitor (Optional)	1	685361	
*	Bearing Housing Cooling Coil Assy (Optional)	1	098308	
* Throat Bushings - See Components and Accessories Price page 10-1301-08.				

\* Not depicted in drawing.

