

Hydraulic Adapter Kit

**BLACKMER® RECIPROCATING
GAS COMPRESSORS**

LB080 & LB160 SERIES



Where Innovation Flows



A compact, lightweight solution that eliminates the need for flywheels in small LPG applications — saving space, reducing weight and simplifying on-site recovery. Eliminating the flywheel reduces the weight by 55 lbs. / 25 kg. Since maximum truck weight is regulated, this allows for more product to be carried in the truck at any given time, maximizing each load, and therefore profitability.

Engineered for seamless integration into Blackmer LB080 and LB160 Series Reciprocating Gas Compressors, the Hydraulic Adapter Kit (patent pending) is a complete, easy-to-install package that transforms your existing setup into a compact, chassis-mounted, hydraulically driven system optimized for mobile LPG applications. In addition to being a retrofit solution, the Hydraulic Adapter Kit is also available as a factory-installed option.

If you're looking to modernize your equipment or enhance performance, the Hydraulic Adapter Kit delivers a quick, easy and cost-effective upgrade that minimizes downtime and maximizes efficiency.

HOW IT WORKS

The Hydraulic Adapter Kit features a precision-machined hydraulic adapter that maintains concentric alignment between the gas compressor and hydraulic motor shafts. This design eliminates the need for a flywheel, eliminates alignment issues, reduces installation time and enhances your overall performance.

Engineered specifically for the LB080 and LB160 Series, the Hydraulic Adapter Kit supports the efficient transfer and vapor recovery of smaller LPG cylinders used in residential, commercial and recreational applications.

FEATURES

- Save Space
- Cut Down on Weight
- Provide Greater Fuel Efficiency
- Eliminate Alignment Issues
- Reduce Installation Time
- Maximize Uptime
- Improve Overall Performance

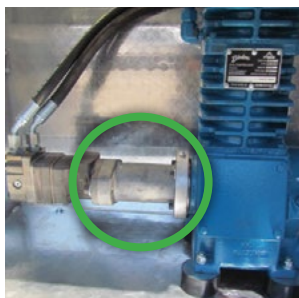

BLACKMER SOLVES SMALL LPG APPLICATION PAIN POINTS

- Hundreds of traditional truck applications are burdened by heavy, space-consuming flywheels (indicated by the **red circle**).
- The Hydraulic Adapter Kit eliminates the need for a flywheel, thereby minimizing weight and maximizing footprint (indicated by the **green circle**).

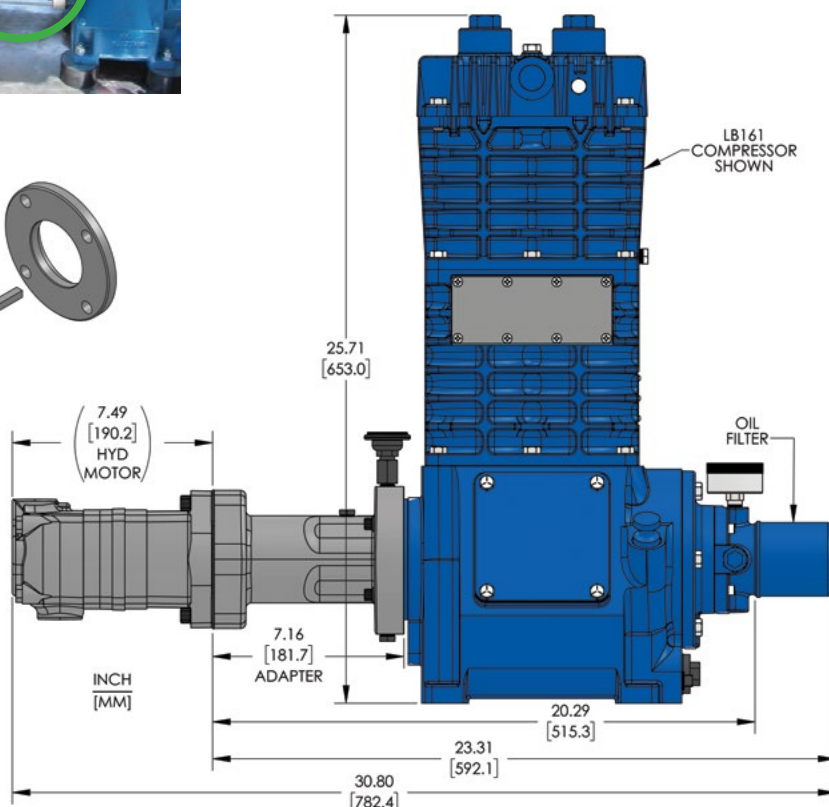
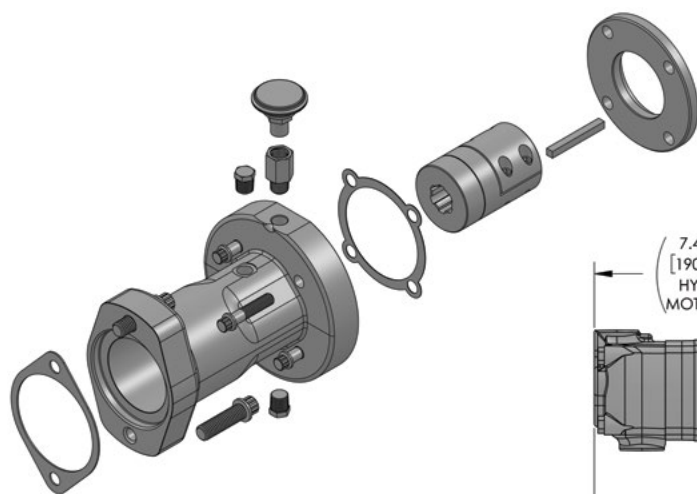

Hydraulic Motor Drive Specification

TORQUE REQUIREMENTS	OUTPUT SHAFT REQUIREMENTS	MOUNTING OPTIONS
LB080 Series – 1320 in*lbs. (150 N*m) @ 740 RPM LB160 Series – 1500 in*lbs. (170 N*m) @ 740 RPM	1" SAE 6B Spline	SAE A – 2 or 4 Bolt

502-005 08/25

Copyright 2025 PSG®, a Dover company

Authorized PSG® Partner:



PSG
1809 Century Avenue SW
Grand Rapids, MI 49503-1530 USA
P: +1 (616) 241-1611
F: +1 (616) 241-3752
info@blackmer.com
blackmer.com

PSG® reserves the right to modify the information and illustrations contained in this document without prior notice. This is a non-contractual document. 08-2025