

Ebsray RV Series – Model RV18 Bypass Valve for LPG Applications



Model RV18

Design

In-line design Bypass/Pressure Relief Valves are used for a wide variety of LPG services. Adjustable differential pressure is attained for accurate and repeatable performance in return-to-tank or bypass systems. This enables full pump flow while maintaining controlled preset maximum pressure.

Features & Benefits

- CBS – Constant Bleed System
- Chatter-free quiet operation
- 90° porting arrangement
- 1" NPT tapped ports. 1" ANSI 300 flanged option.
- Adjustable pressure setting
- Low pressure rise
- VRS – Vapor Removal System

Assured Quality & Performance

ISO9001 Quality System assures compliance with the high safety and quality standards demanded by the LPG industry

Pumps are listed by Underwriters Laboratories for LP-gas service.



Ebsray RV Series – Model RV18

Bypass Valve for LPG Applications

Maximum Operating Limits

Pump Model	Flow Rate ³		Differential Pressure ²		Hydrostatic Test Pressure	
	gpm	L/min	psi	bar	psi	bar
RV18	52	200	203	14	1,015	70

Porting:

1" NPT tapped

¹ Downstream system resistance will affect differential pressure.

² Spring selection to suit required pressure range.

³ Pressure rise is dependent upon flow through Bypass Valve

NOTE: All specifications and illustrations are typical only and subject to revision without notice. Certified data available upon request.

ADJUSTING SCREW

- Easy access, simple to adjust
- Positive locking
- Leak free during adjustment

SEALING

- O-ring
- Simple to service

CASING

- Ductile iron to ASTM A395
- Assembled valve hydrostatically tested to 1,015 psi (70 bar)

SPRING

- Adjustable within spring pressure range ^{1,2}
- High quality spring steel

VALVE

- Spool type quiet operation
- CBS (Constant Bleed System) *Standard (optional VRS)*

PORTS

- 1" NPT tapped
- Ease of installation service

Dimensions

Pump Model		A	B	C	Ports	Weight
RV18	in	2.17	2.6	5.3	1" NPT	13.9 lbs
	mm	55	66	135	Tapped	6.3 kg

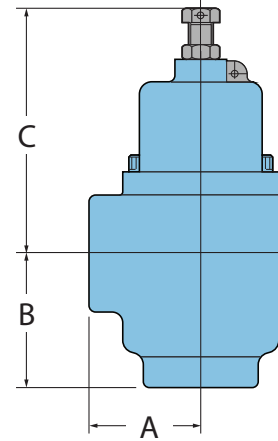

Optional

Integral "excess flow" type VRS. (Vapor Removal System)

- Rapid Vapor Clearing
- Efficiency – after vapor clearing is completed "excess flow" valve closes fully. This ensures full pump outlet is available at discharge point.
- Interchangeable with standard Spool Valve. (CBS)

VAPOR PATH

- Low Resistance (when in priming mode)

SPRING

- Stainless steel

BALL

- Non-metallic for quiet actuation and positive sealing

Process | Energy | Military & Marine
 PSG Grand Rapids
 1809 Century Avenue SW, Grand Rapids, MI 49503-1530 USA
 T 616.241.1611 • F 616.241.3752
blackmer.com



Authorized PSG® Partner: