

Hand Operated Sliding Vane Pumps

HAND PUMPS FOR TRANSFER & DISPENSING | PRODUCT BROCHURE

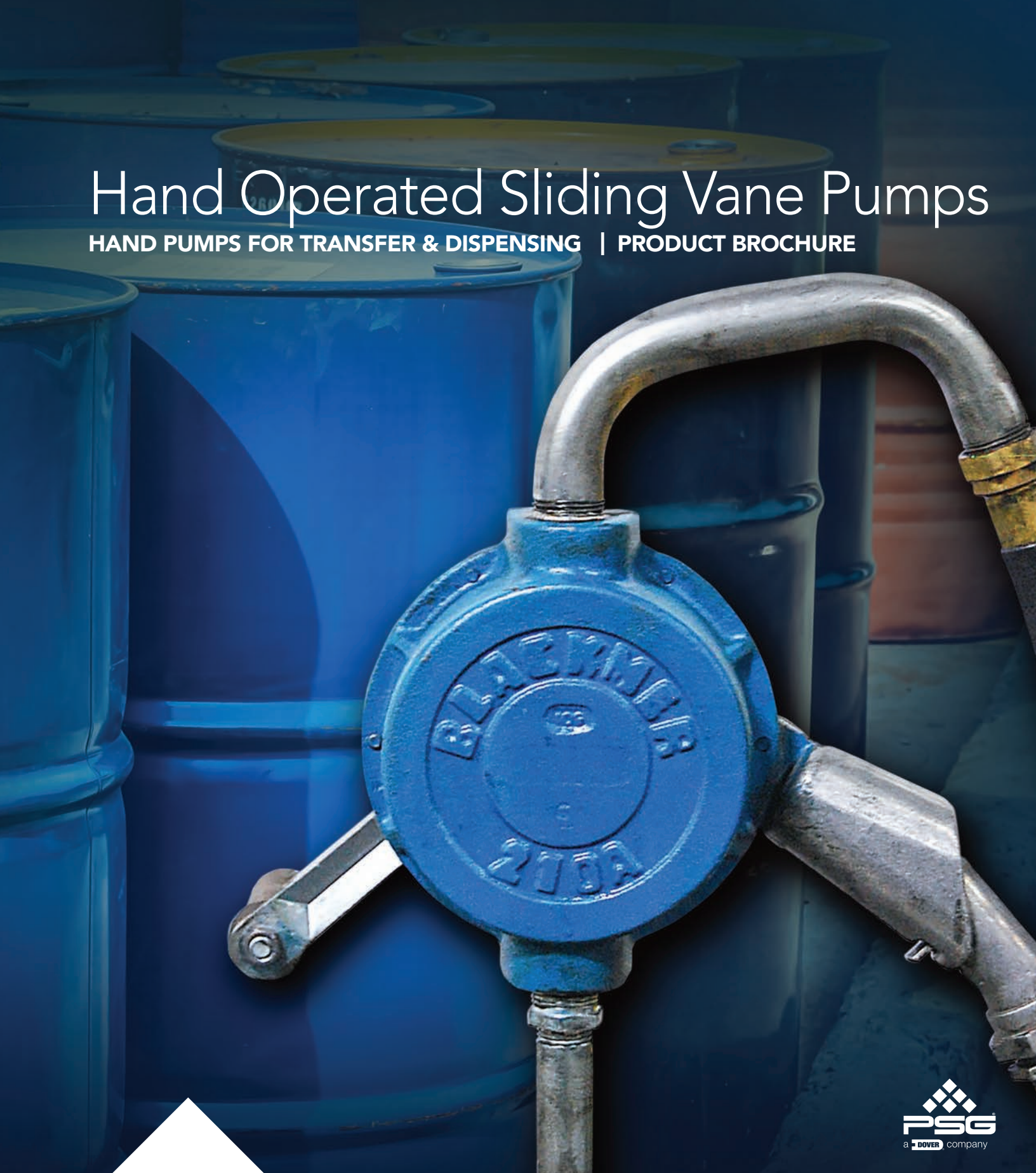

Blackmer

Where Innovation Flows



Blackmer® Sliding Vane Hand Pumps provide a safe, convenient method of dispensing or transferring non-corrosive liquids from drums, barrels, tanks or vats. They are designed for easy, efficient operation in handling a wide range of liquids in industrial, construction and agricultural applications.

FOR ALL TYPES
OF TRANSFER
& DISPENSING
APPLICATIONS

Hand Operated Sliding Vane Pumps

Rugged Construction / Superior Quality / Proven Reliability

Operating on the same principle as Blackmer power pumps, these positive displacement, self-priming, sliding vane pumps provide steady, non-pulsating flow at easy turning speeds. Cylinder and head are of cast iron construction for greater durability. The carbon sliding vanes are tough, low-friction, chemically inert, and long wearing. The vanes self-compensate for wear to maintain high-suction lift and are easily replaced at low cost after years of service. With exceptionally rugged construction, Blackmer Sliding Vane Hand Pumps assure users of long service life and reliable performance.

World-class Quality - ISO 9001 Certified

Blackmer Sliding Vane Hand Pumps are produced in conformance with ISO 9001 certification. Each pump is performance tested to ensure the highest quality standards. The worldwide reputation of Blackmer for superior product quality begins with computer aided design and integrated manufacturing capabilities.

Field Proven Reliability

Blackmer was first established in 1903, and has been manufacturing rotary hand pumps in the U.S.A. since that time. Today, Blackmer is the world's leading manufacturer of rotary vane pumps. Blackmer Hand Pumps may cost a little more, however, their exceptionally rugged construction assures long service life and reliable performance, year after year.



Mounting Styles



PA:
Basic Pump for
In-line Installation



AT:
Standard Dispensing Pump with
Discharge Spout & 40"
Suction Pipe



DPF:
FM-approved Dispensing Pump
with Drip Pan, Discharge Spout &
40" Suction Pipe



BR & BRF:
Standard and FM-approved
Transfer Pump with Discharge
Hose, Nozzle & 40" Suction Pipe

Applications

- LIQUID DISPENSING:** Pumping petroleum products, solvents, coolants or curing agents from barrels or drums into smaller containers for convenient handling, sales, or small quantity use.
- LIQUID TRANSFER:** Moving fuels, solvents, commercial and process liquids from drums to other large tanks with a hose and nozzle, as in refueling diesel or gasoline powered vehicles or equipment.
- OEM APPLICATIONS:** With pumps mounted directly on agricultural or off-road equipment for standby fueling or pre-lubricating of bearing surfaces on large diesel engines before start-up.
- IN-LINE SYSTEMS APPLICATIONS:** Transfer of fuels, solvents, and other liquids from one large container to another by means of a permanently piped, fixed system with the pump as an integral part of a transfer line. Often used to move liquids from central or nearby outside storage to in-plant drums or tanks.
- FLAMMABLE LIQUIDS HANDLING:** FM Approved models meet OSHA safety guidelines and regulations for handling Class I and Class II flammable and combustible liquids like gasoline, naphtha, solvents, and thinners.

Technical Data

PUMP MODEL	FRAME SIZE	NOMINAL FLOW RATE AT 115 REV	PORT SIZE NPT	MAX. VISCOSITY SSU (cP)	MAX. PRESSURE	MAX. TEMP.
		gpm (L/min)	in. (mm)	SSU (cP)	psi (bar)	°F (°C)
210A	Small Frame	10 (38)	3/4" (19)	2,000 (420)	10 (0.7)	300 (149)

STYLE	SMALL FRAME	
	STANDARD	FM-APPROVED
In-line	PA210A	—
Dispensing	AT210A	DPF210A
Transfer	BR210A	BRF210A

PUMP MODEL	A	B	C	D	E	F
PA210A	in.	1 3/16	9 1/16	6	6 1/4	3 1/2
	mm	30	246	152	159	89

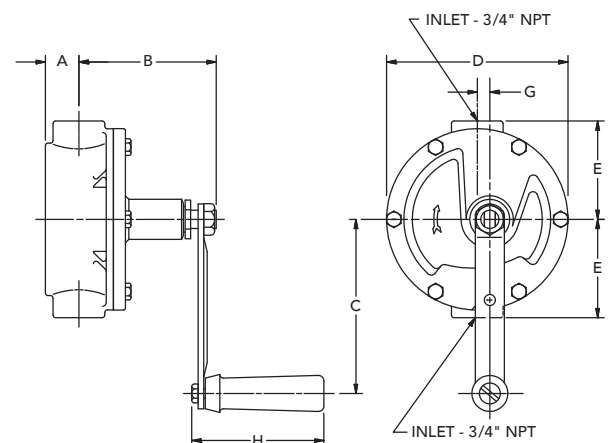



PSG Grand Rapids
1809 Century Avenue SW
Grand Rapids, MI 49503-1530
USA
P: +1 (616) 241-1611
info@blackmer.com
psgdover.com/blackmer



Where Innovation Flows

301-001 0622

Authorized PSG® Partner:

Copyright 2022 PSG®, a Dover company